

# SUPERSAM

UL. ks. Piotra Skargi 6, KATOWICE

REV. 00 - 17.11.2022

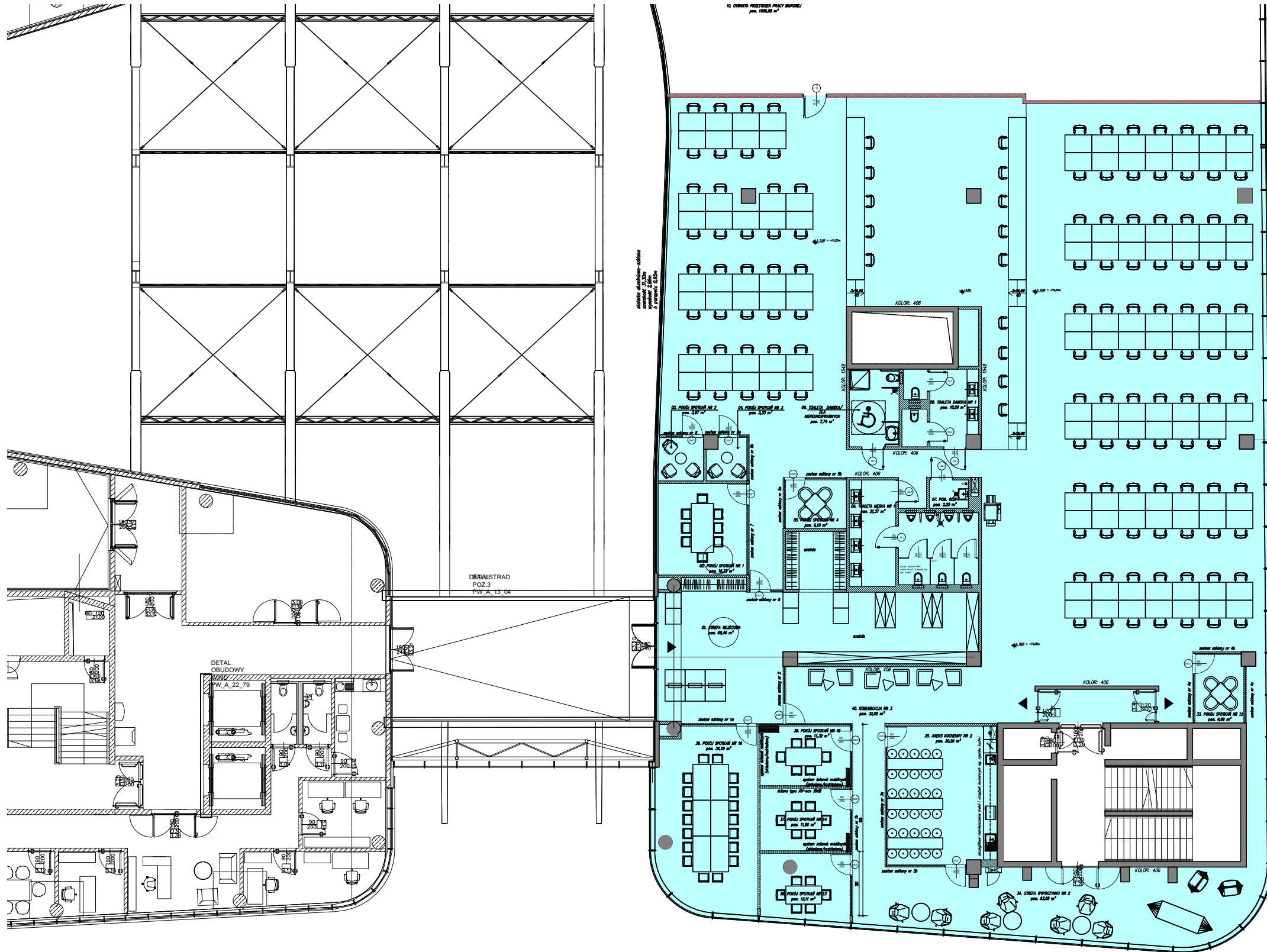

PIĘTRO: +3  
POWIERZCHNIA (NETTO): ~933m<sup>2</sup>

SKALA: 1:200

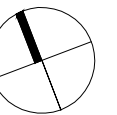

**globalworth**  
PPPP

GPRE Management Sp. z o.o. part of Globalworth Group  
Twarda 18 St., 00-105 Warsaw, Poland

prepared by: arch. Henryk Dasiukiewicz